

Z34X-SWRL

**** Recommended to install ALL hoses and the bracket PRIOR to installing into final position due to space limitations ****

Strut Brace, Battery and Brake trim pieces must be removed to access swirl pot mounting location

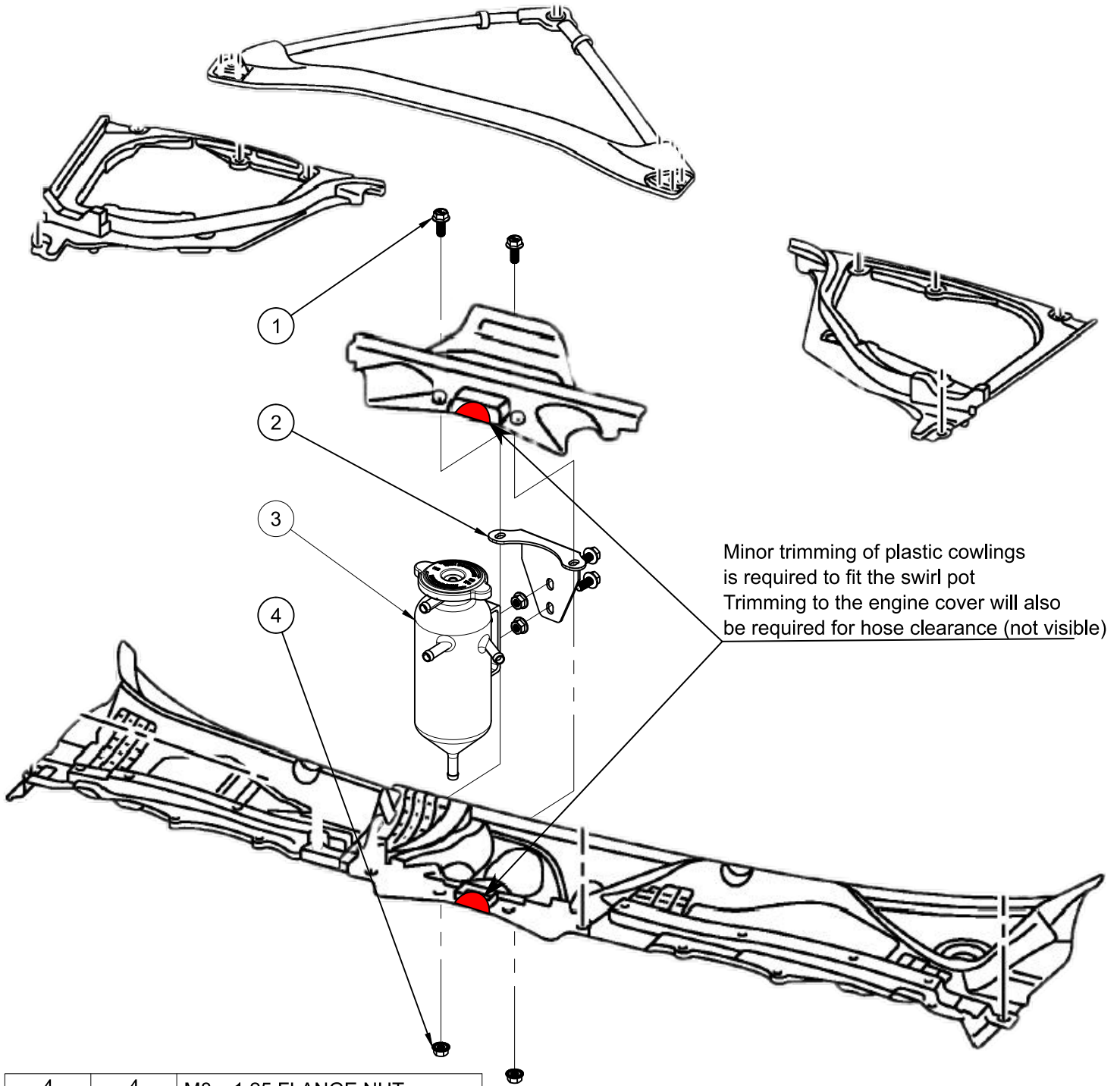

Minor trimming of plastic cowlings is required to fit the swirl pot
Trimming to the engine cover will also be required for hose clearance (not visible)

4	4	M8 x 1.25 FLANGE NUT
3	1	SWIRL POT
2	1	370Z SWIRL POT BRACKET
1	4	M8 x 1.25 x 25 FLANGE BOLT
Item	Qty	Part Name
Parts List		