

# Z33X/Z34X-SLVE WELD IN SLEEVE

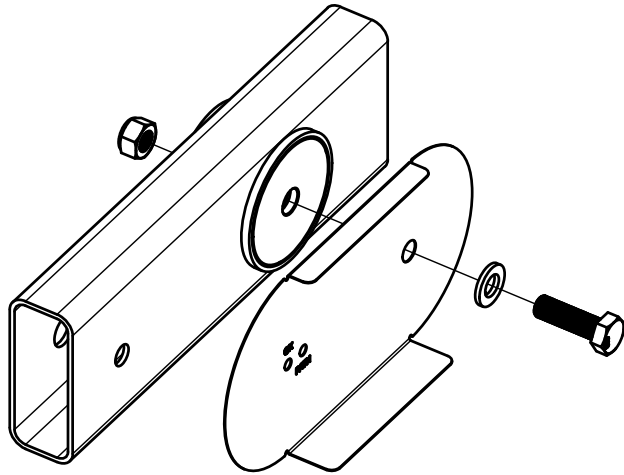

Ensure to choose the correct hole  
PATHFINDER = OEM Pathfinder diff cover  
GK = GKTECH Billet diff cover

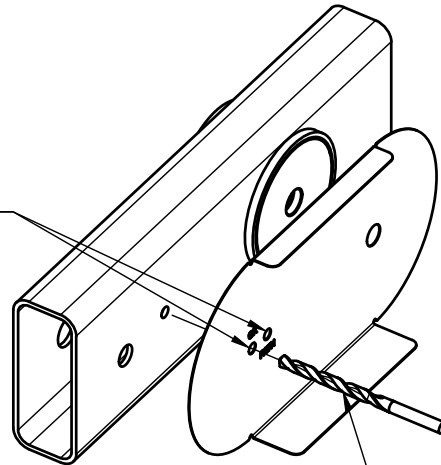

Use regular drillbit to make a  
pilot hole for holesaw  
Metric - **6.0mm**  
Imperial - **1/4"**

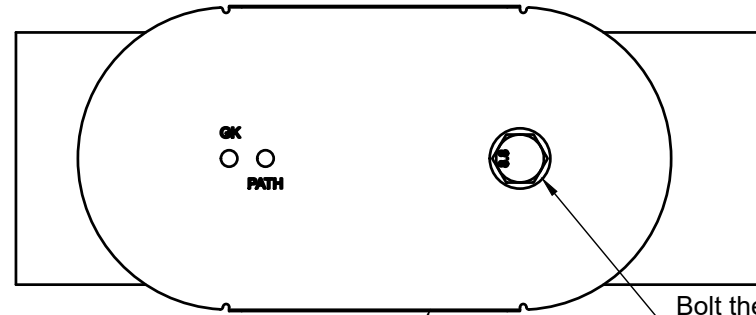

Ensure guide is level

Bolt the guide to the diff bush

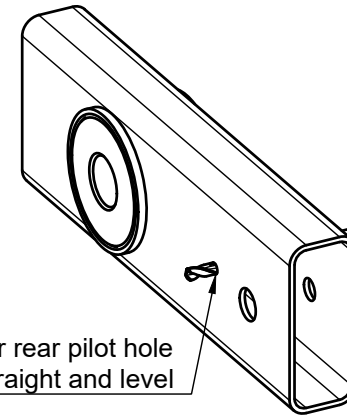

Drill through entire subframe for rear pilot hole  
Ensure drill is straight and level

# Z33X/Z34X-SLVE

## WELD IN SLEEVE

Use holesaw to drill front hole  
Metric - 76mm  
Imperial - 3"

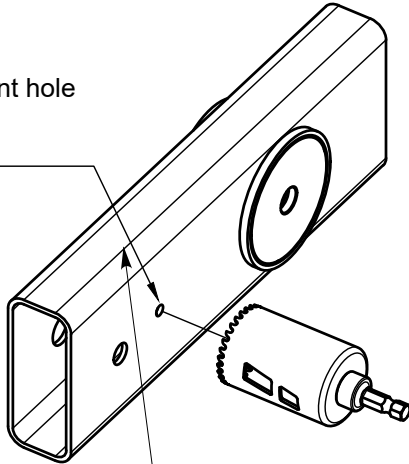

On Z34 subframes, the holesaw will cut all the way through the top of the subframe, this is expected and welded the bush in will add this strength back in plus more

Use holesaw to drill rear hole

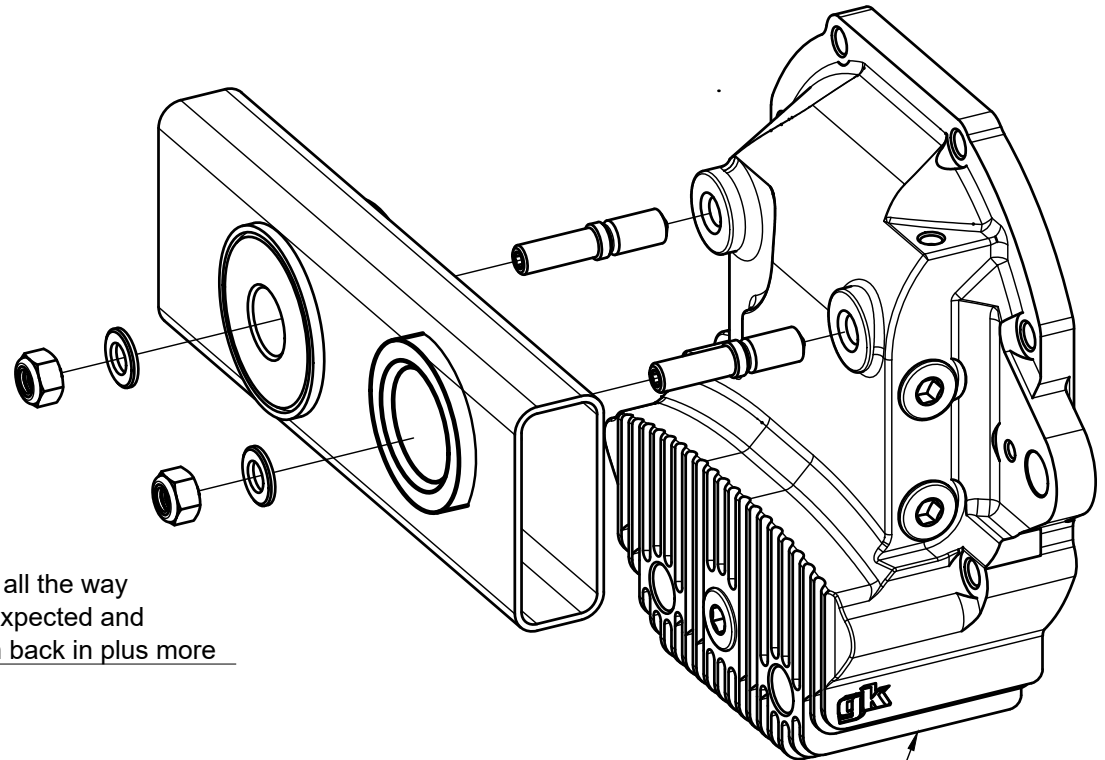
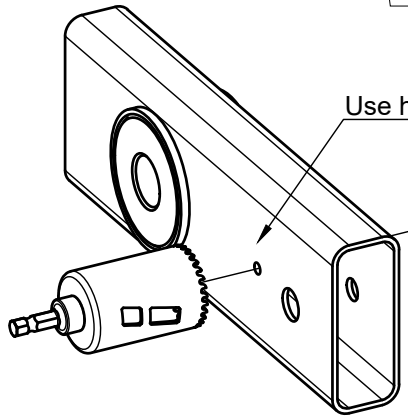

Install the differential with GK or Pathfinder cover to ensure bushing alignment  
Tac weld in place before removing differential and fully welding  
Welding should mimic the OEM welding