

# ***XE10-RKBT***

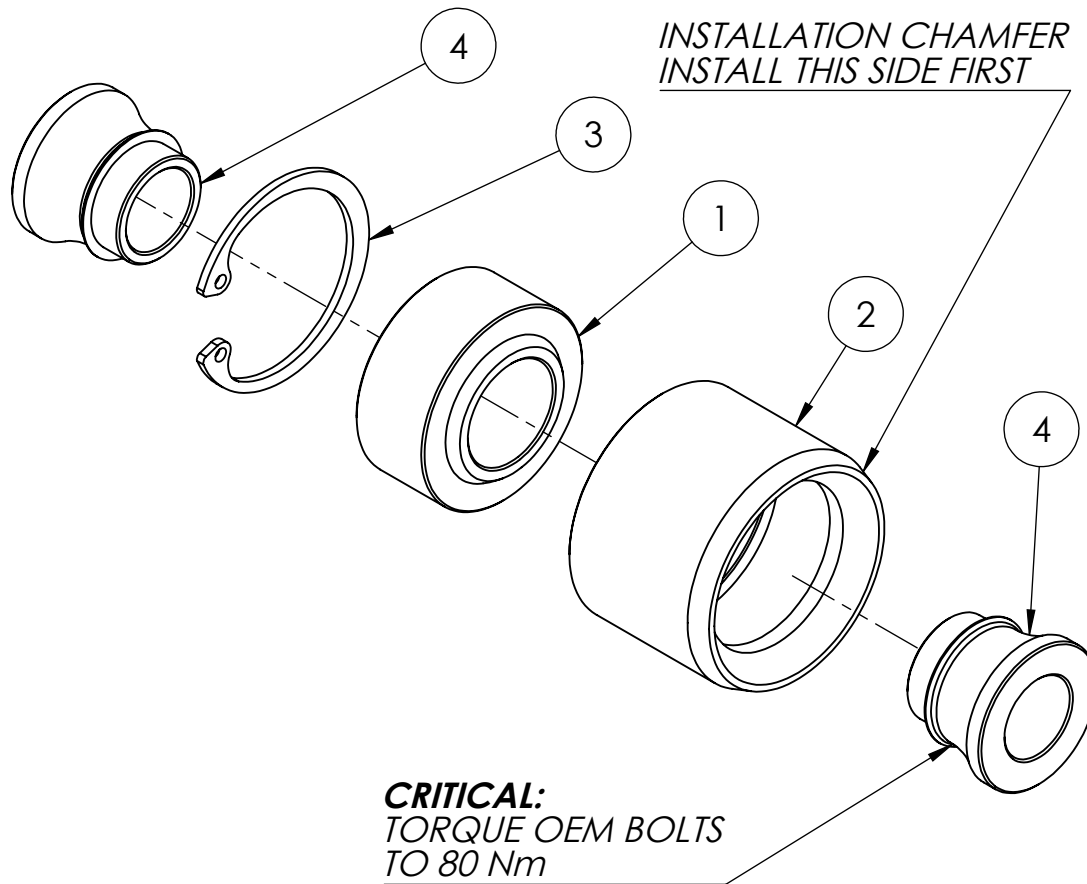

1. *PRESS OUT THE OEM TRACTION ARM BUSHINGS.*
2. *PRIOR TO INSTALLING THE BEARING, LIGHTLY SAND AND CLEAN THE KNUCKLE SURFACE.*
3. *PRESS IN NEW SPHERICAL BEARINGS USING THE INSTALLATION CHAMFER. PRESS THE HOUSING IN BY APPLYING FORCE ON THE OUTER EDGE.*

ITEM NO.	DESCRIPTION	QTY.
1	COM10-T SPHERICAL BEARING	1
2	XE10 REAR KNUCKLE TRACTION ARM SPHERICAL HOUSING	1
3	DIN 472, Internal Retaining Ring	1
4	COM10T SPACER 12.2x39.75 - MM	2