

XE10-RKBL

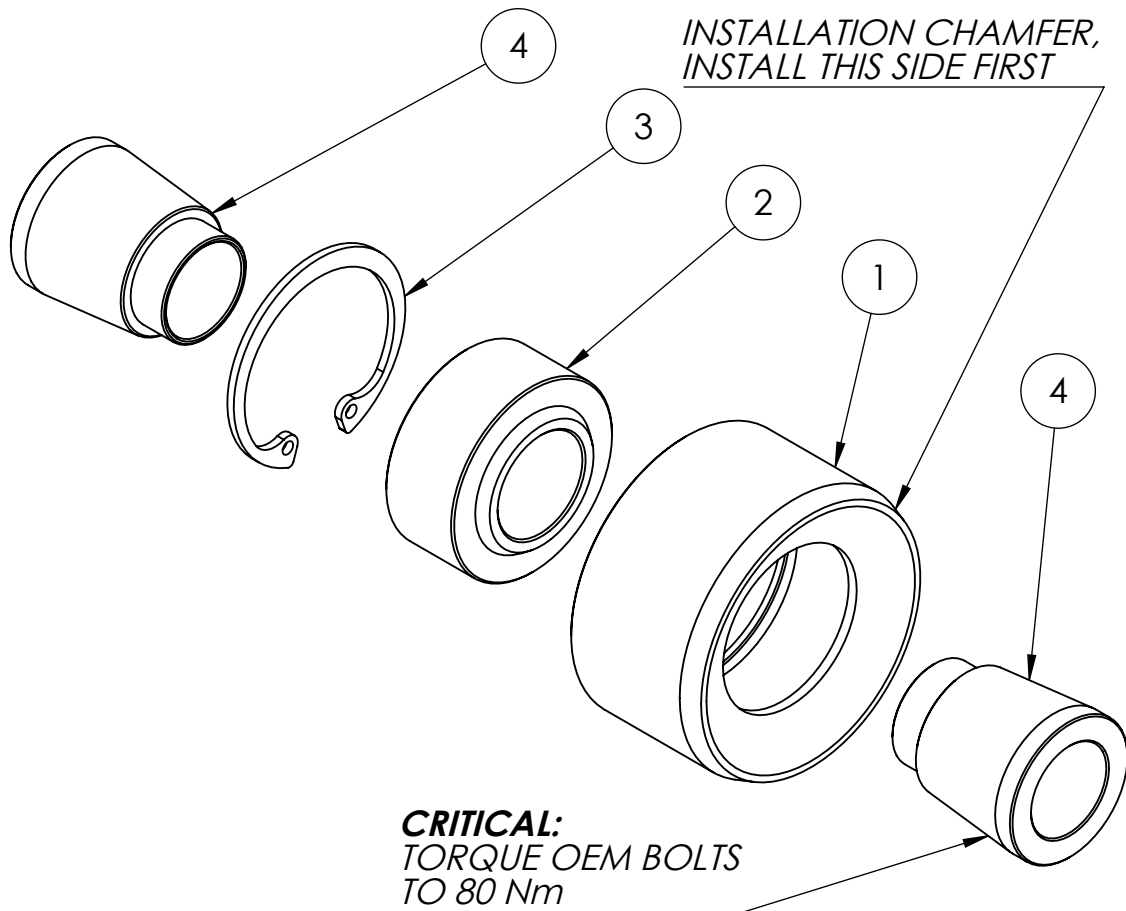

1. PRESS OUT THE OEM LOWER CONTROL ARM BUSHINGS.

CRITICAL - CONFIRM THE OUTER DIAMETER OF THE OEM BUSH MATCHES THE REPLACEMENT. FOR VARIANCES UP TO 0.25MM, WE RECOMMEND USING LOCTITE 638.

2. PRIOR TO INSTALLING THE BEARING, LIGHTLY SAND AND CLEAN THE KNUCKLE SURFACE.
3. PRESS IN NEW SPHERICAL BEARINGS USING THE INSTALLATION CHAMFER. PRESS THE HOUSING IN BY APPLYING FORCE ON THE OUTER EDGE.

ITEM NO.	DESCRIPTION	QTY.
1	XE10 REAR KNUCKLE LCA SPHERICAL HOUSING	1
2	COM10-T SPHERICAL BEARING	1
3	DIN 472, Internal Retaining Ring	1
4	COM10-T SPACER 14ID 55W	2