

XE10-RKBL

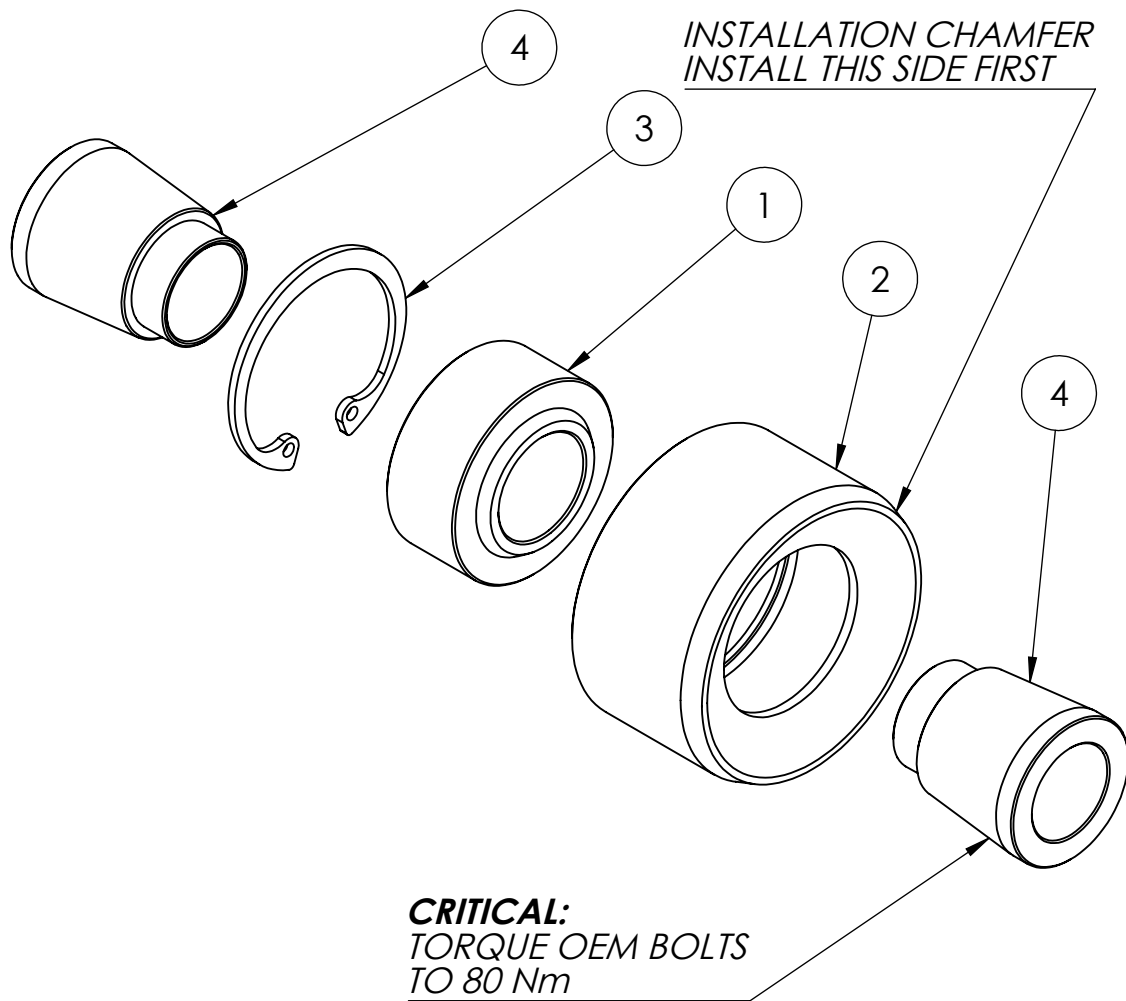

1. *PRESS OUT THE OEM LOWER CONTROL ARM BUSHINGS.*
2. *PRIOR TO INSTALLING THE BEARING, LIGHTLY SAND AND CLEAN THE KNUCKLE SURFACE.*
3. *PRESS IN NEW SPHERICAL BEARINGS USING THE INSTALLATION CHAMFER. PRESS THE HOUSING IN BY APPLYING FORCE ON THE OUTER EDGE.*

ITEM NO.	DESCRIPTION	QTY.
1	COM10-T SPHERICAL BEARING	1
2	XE10 REAR KNUCKLE LCA SPHERICAL HOUSING	1
3	DIN 472, Internal Retaining Ring	1
4	COM10-T SPACER 14ID 55W	2