

JZXX-RKBT

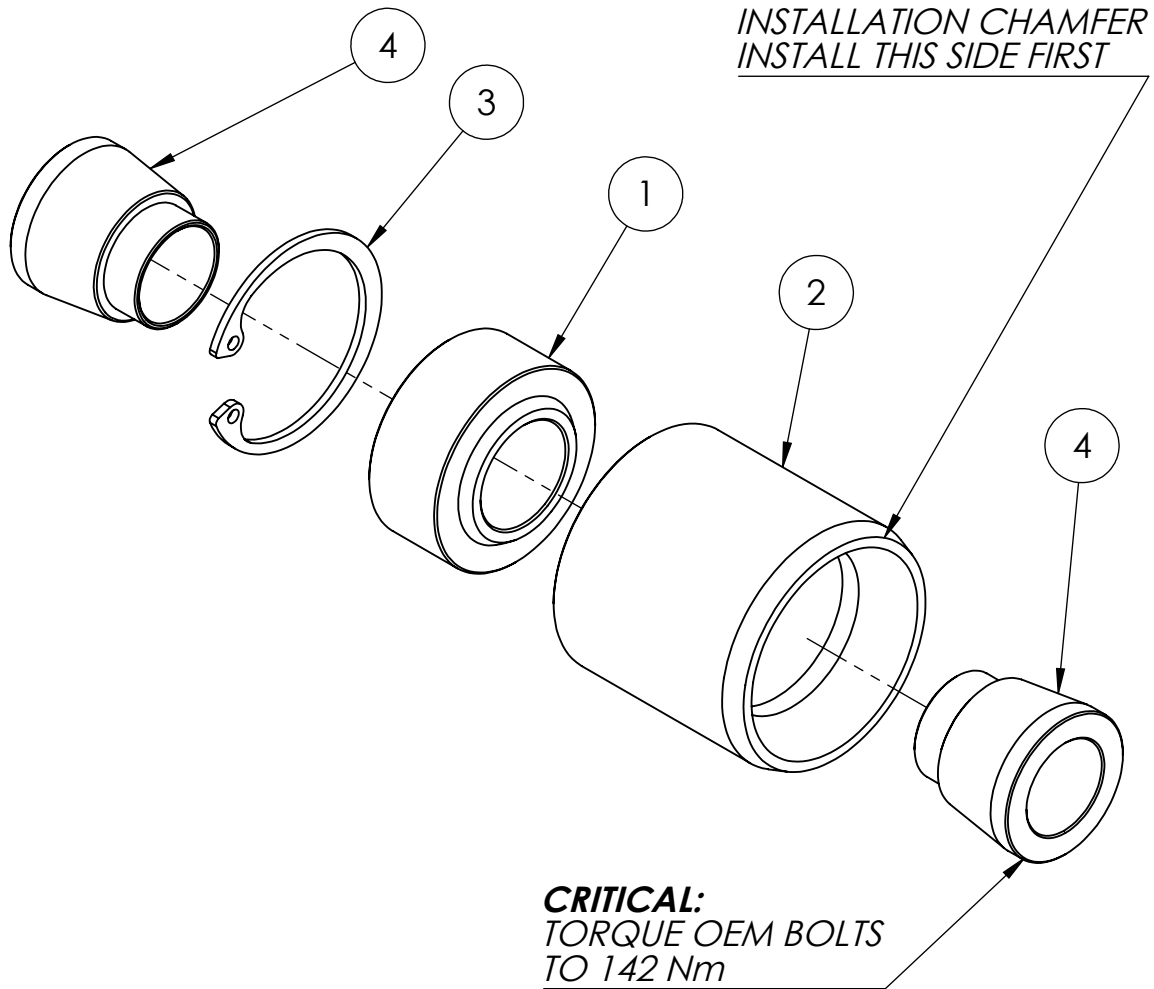

1. PRESS OUT THE OEM TRACTION ARM BUSHINGS.
2. PRIOR TO INSTALLING THE BEARING, LIGHTLY SAND AND CLEAN THE KNUCKLE SURFACE.
3. PRESS IN NEW SPHERICAL BEARINGS USING THE INSTALLATION CHAMFER. PRESS THE HOUSING IN BY APPLYING FORCE ON THE OUTER EDGE.

ITEM NO.	DESCRIPTION	QTY.
1	COM10-T SPHERICAL BEARING	1
2	JZX100 REAR KNUCKLE TRACTION ARM SPHERICAL HOUSING	1
3	DIN 472, Internal Retaining Ring	1
4	COM10-T SPACER 14ID 45W	2