



GKTech.com.au is the manufacturer of all parts sold under GKTech brand. All parts are produced overseas by standards and requirements set by GKTech engineer.

- 1) Rod end used has Steel 52100 inner ball and 25CrMo4 heat treated race with PTFE lining for lubrication. Ultimate radial static load: 129kN
- 2) Rod end spacers are 6061-T6 aluminium
- 3) Vernier sleeve/thread adjuster is with inner  $\frac{3}{4}$ -16 UNF 3B inner thread, M27x2 grade A outer thread and CNC machined from 25CrMo4 steel
- 4) Welding assembly is welded together in a jig using GTAW welding method and meet EN ISO 13920-B for tolerances and EN ISO 5817-C for quality.
- 5) The welded assembly is all steel 4130 material. The tubing is 28x3. M27x2 threaded tube end and flat section is 12mm thick for bolt mounting areas and has 10mm overlap with tubing CNC machined steel for precise fit.
- 6) All hardware is minimum 8.8 class and zinc coated for corrosion prevention

Design process involves calculating loads at different suspension mounting points during cornering and braking scenarios and applying them to design models using Finite Element Analyses and the topology is optimised to meet minimum 4x safety margin for material stress.

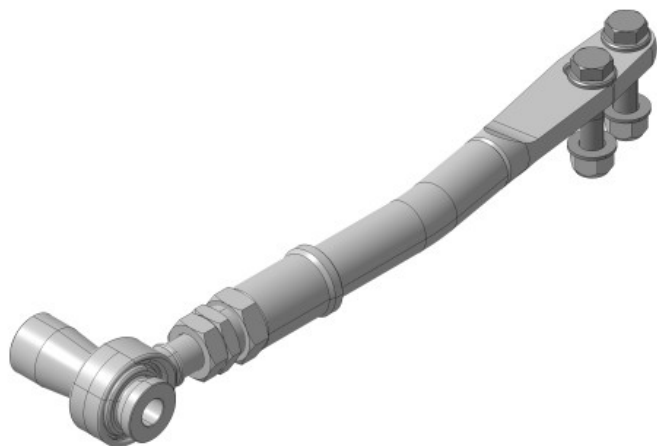

Figure 1. GKtech skyline and skyline GT-R tension rod