

**OEM BUSH REMOVAL**

1. APPLY GENERAL PURPOSE GREASE TO THREADS
2. INSTALL PARTS AS SHOWN IN (FIGURE A)
3. SLOWLY TIGHTEN THE FREE NUT TO PULL THE BUSH OUT - ENSURE THE PULL WASHER STAYS ALIGNED AND DOES NOT GET STUCK
4. CONTINUE UNTIL BUSH IS REMOVED

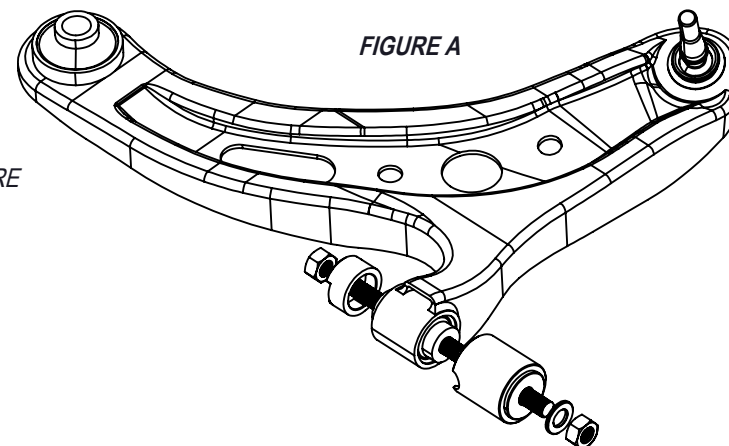

FIGURE A

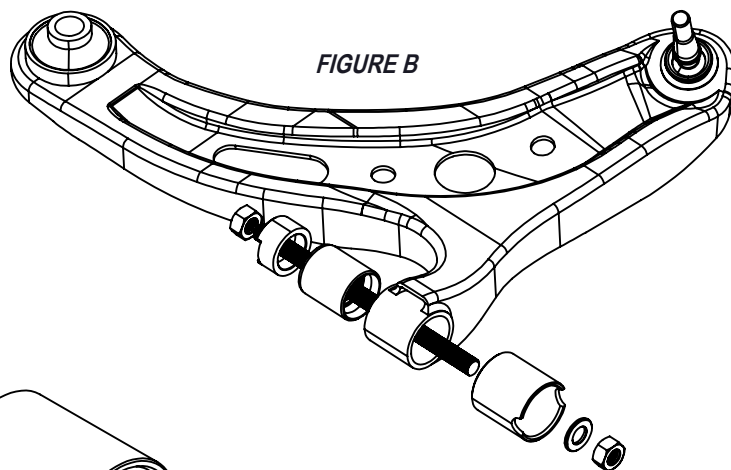

FIGURE B

**GK SPHERICAL INSTALLATION - PART A**

1. APPLY GENERAL PURPOSE GREASE TO THREADS
2. INSTALL PARTS AS SHOWN IN (FIGURE B)
3. SLOWLY TIGHTEN THE FREE NUT INSIDE THE CUP TO PULL THE BEARING INTO THE ARM - ENSURE THE BEARING STAYS ALIGNED AND DOES NOT GET STUCK
4. CONTINUE UNTIL BEARING HITS CUP INTERNALLY (THE BUSH WILL NOT BE FULLY INSTALLED YET)

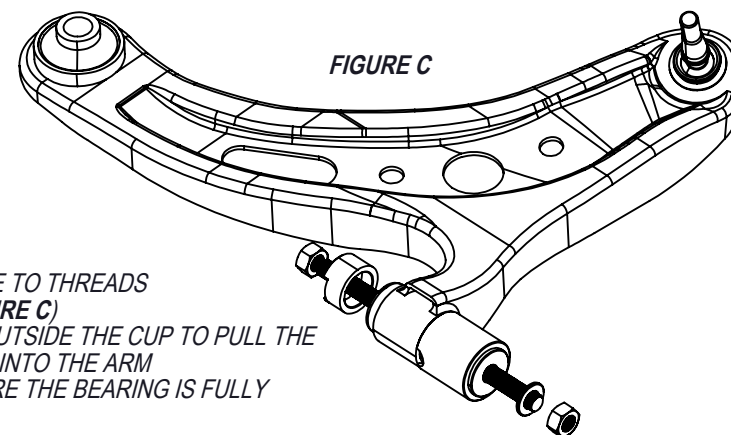
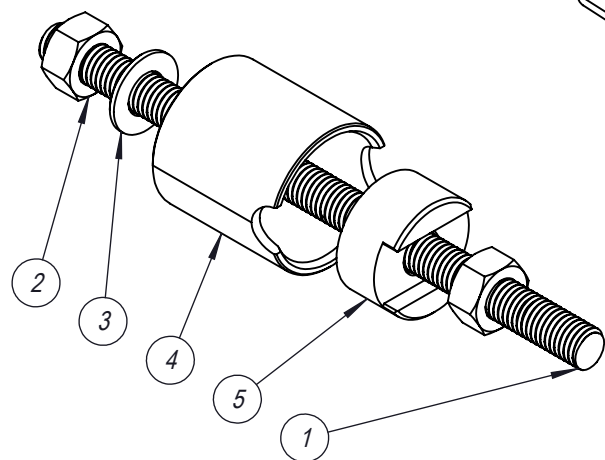

FIGURE C

**GK SPHERICAL INSTALLATION - PART B**

1. APPLY GENERAL PURPOSE GREASE TO THREADS
2. INSTALL PARTS AS SHOWN IN (FIGURE C)
3. SLOWLY TIGHTEN THE FREE NUT OUTSIDE THE CUP TO PULL THE BEARING THE REMAINING AMOUNT INTO THE ARM
4. USE THE SIGHTING HOLE TO ENSURE THE BEARING IS FULLY SEATED

ITEM NO.	DESCRIPTION	QTY.
1	DIN 975 M12 x 1.75 x 200 THREADED ROD GRADE 12.9 BLACK	1
2	DIN 934 M12 x 1.75 NUT GRADE 12.9 BLACK	2
3	DIN 125 M12X24X2 Washer	1
4	36MM CLEARANCE CUP	1
5	36MM PULL WASHER	1