

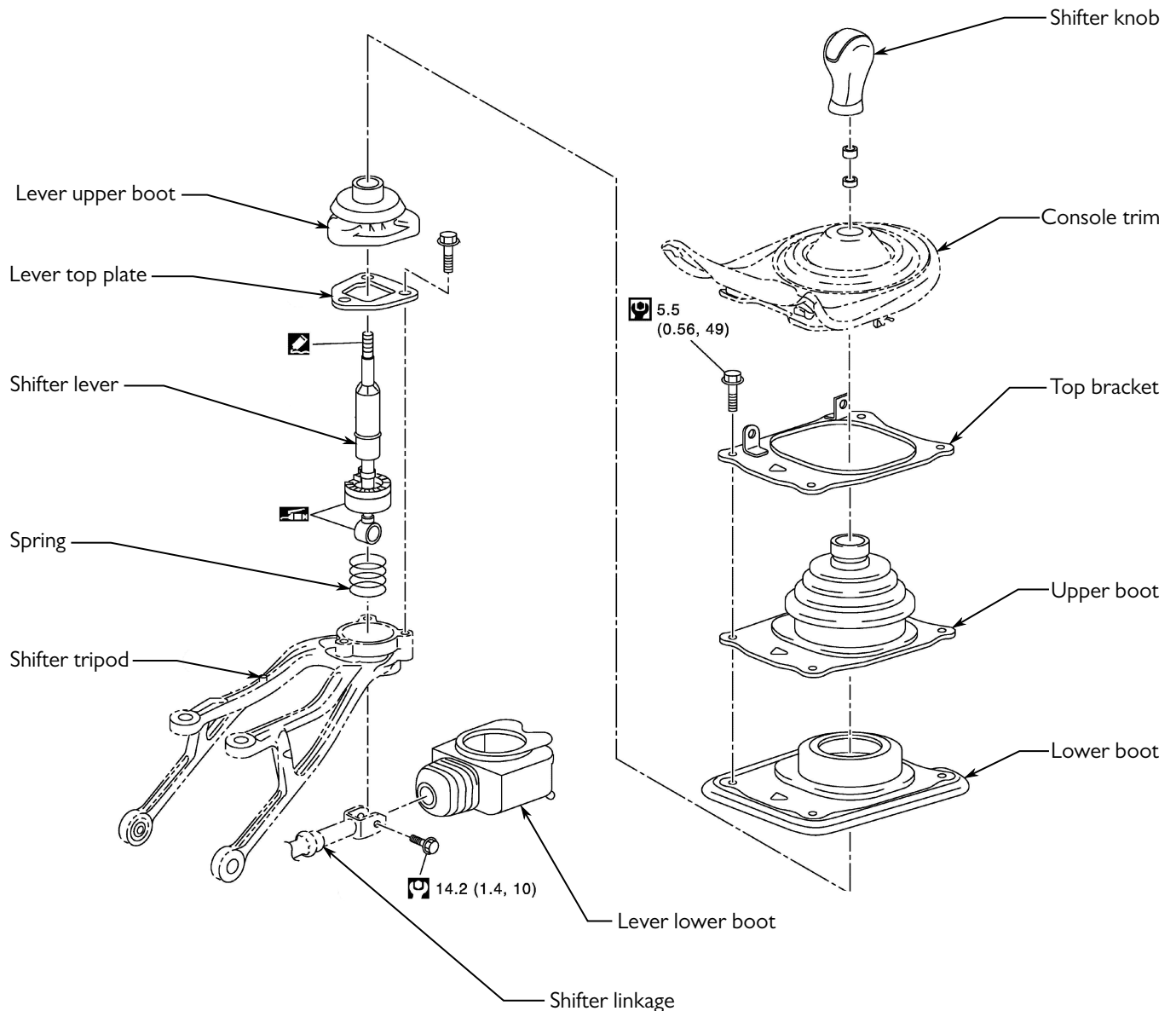

CD009 SHORT SHIFTER ASSEMBLY GUIDE

1. Begin by placing the car on a hoist or jack stands with adequate room to access the gearbox
2. Remove the following parts:
 - Shifter knob
 - Console trim
 - Top bracket
 - Upper boot and Lower boot
3. Under the car, peel back the lever lower boot
3. Remove the shifter lever lower bolt
4. Back inside the car, remove the remaining parts:
 - Lever upper boot
 - Lever top plate
 - Shifter lever
 - Spring





CD009 SHORT SHIFTER ASSEMBLY GUIDE

1. Support the gearbox with transmission jack
2. Remove 4 x bolts from crossmember
3. Lower the transmission to improve access to the 2 x top tripod bolts

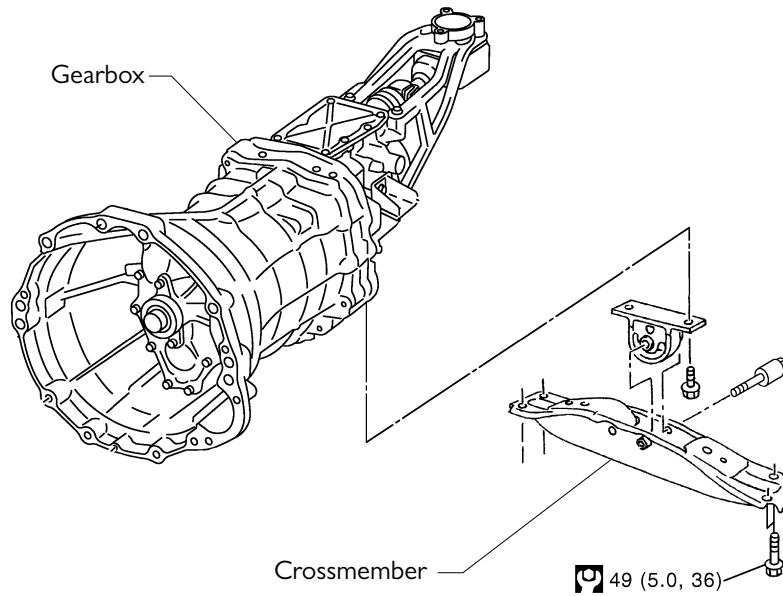

4. Remove 4 x tripod bolts from the gearbox
5. Remove the OEM tripod bracket

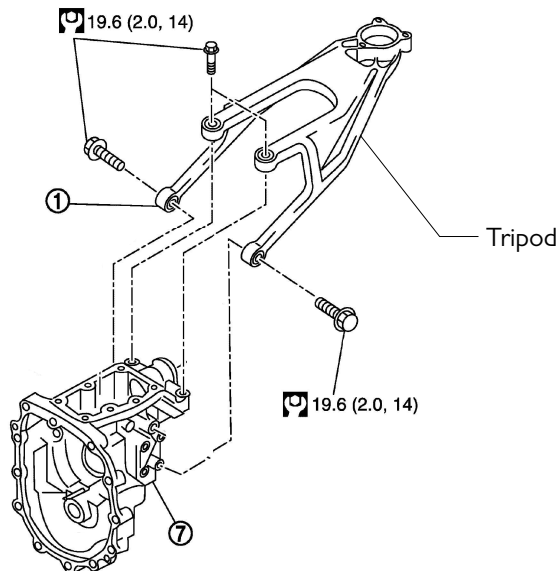



CD009 SHORT SHIFTER ASSEMBLY GUIDE

1. Remove the spring pin holding the OEM linkage in place and remove the OEM linkage
2. Install the Shifter clevis using the new Spring pin supplied

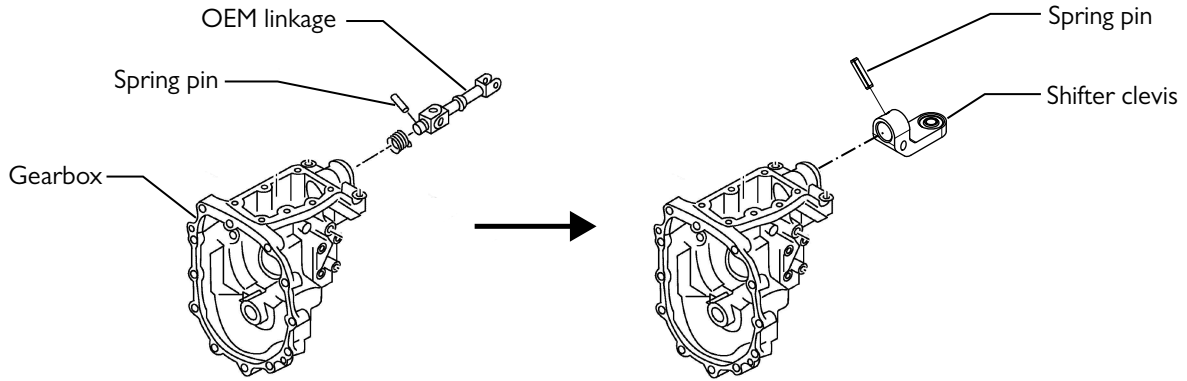

3. Ensure the spacers are installed between the gearbox and adapter bracket
 4. Install the adapter bracket using the M8 bolts supplied and torque to specification shown below
- **The tail shaft may need to be removed to have adequate clearance to install the bracket****

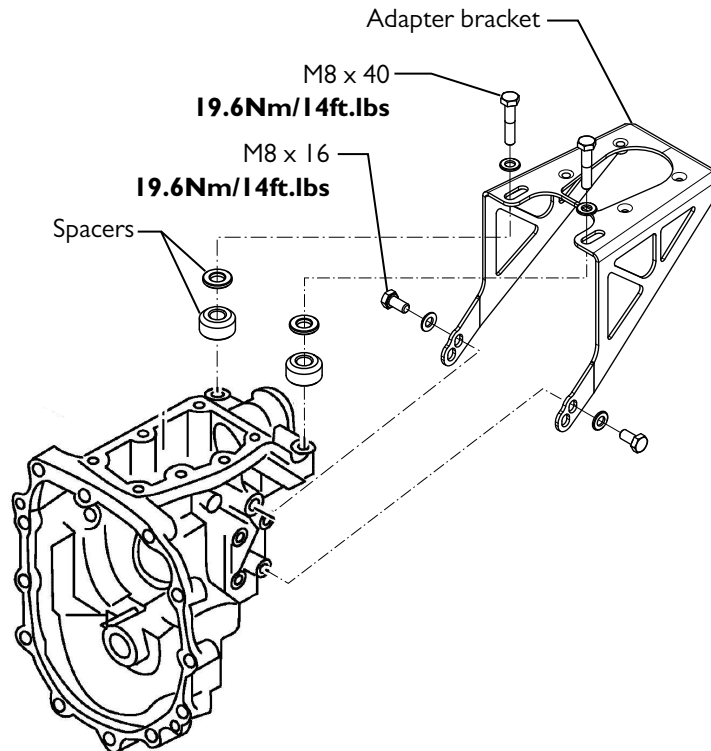



CD009 SHORT SHIFTER ASSEMBLY GUIDE

1. Install Shifter ASM onto Base plate using the 4 x M6 bolts supplied
2. Torque to specification shown below and use **Loctite 243** or equivalent

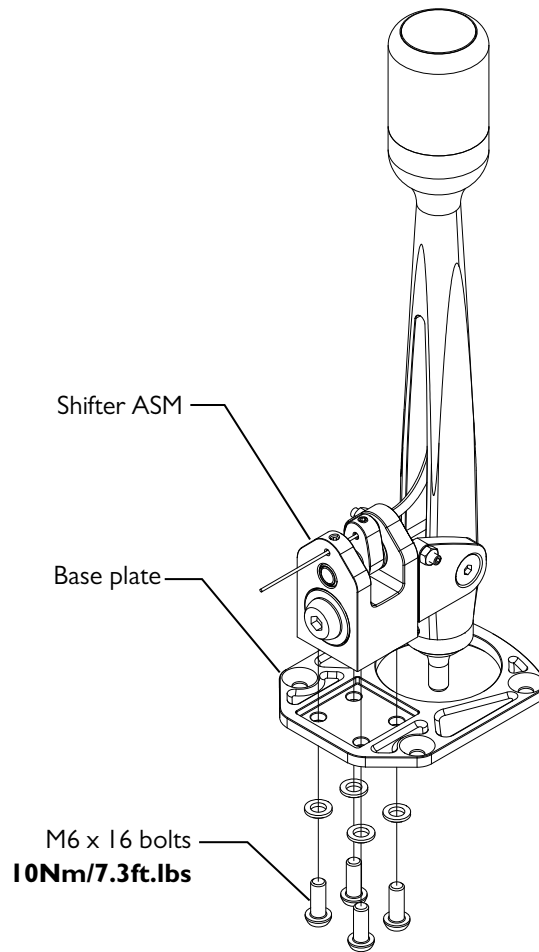
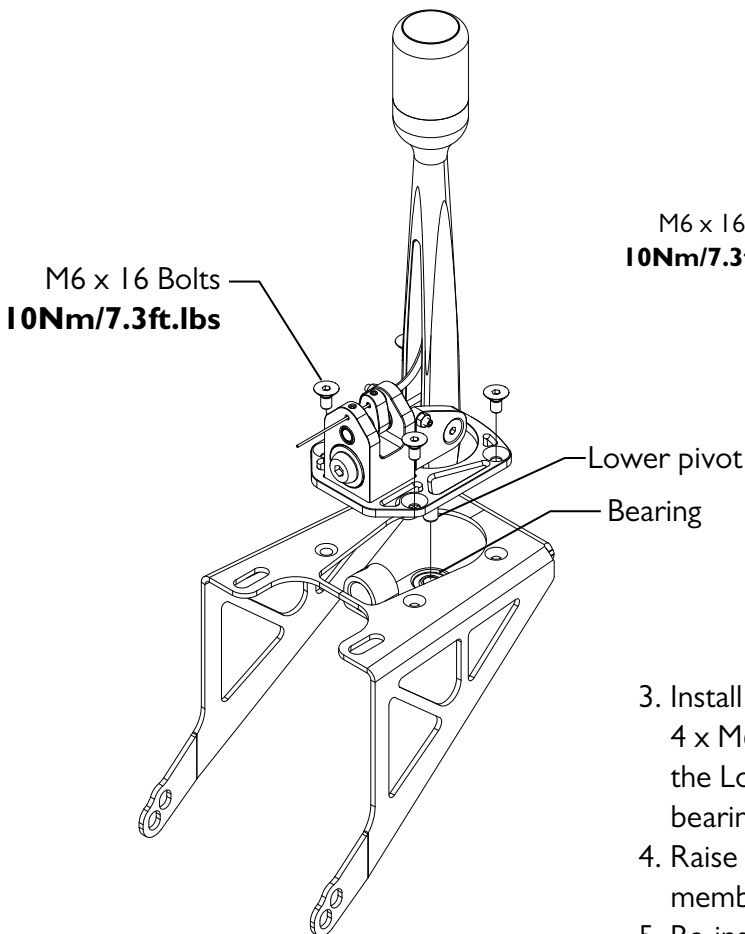

3. Install Base plate onto the Adapter bracket using the 4 x M6 x 16 countersunk bolts supplied, ensure that the Lower pivot of the shifter is inserted into the bearing of the Shifter clevis
4. Raise gearbox back into position and torque cross member bolts to specification **49Nm/36ft.lbs**
5. Re-install any remaining parts such as tail shaft (if removed), trims or shifter boots.



CD009 SHORT SHIFTER ASSEMBLY GUIDE

1. Fully adjust the set screws outwards
2. Place the shifter lever into **REVERSE** gear
3. Adjust the set screw inwards and stop just before contact is made with the Lockout shaft
4. Hold Adjustment screw in place and lock the Adjuster nut
5. Confirm smooth operation into 5/6 gear without getting stuck on reverse gate, if contact is made adjust the set screw further inwards

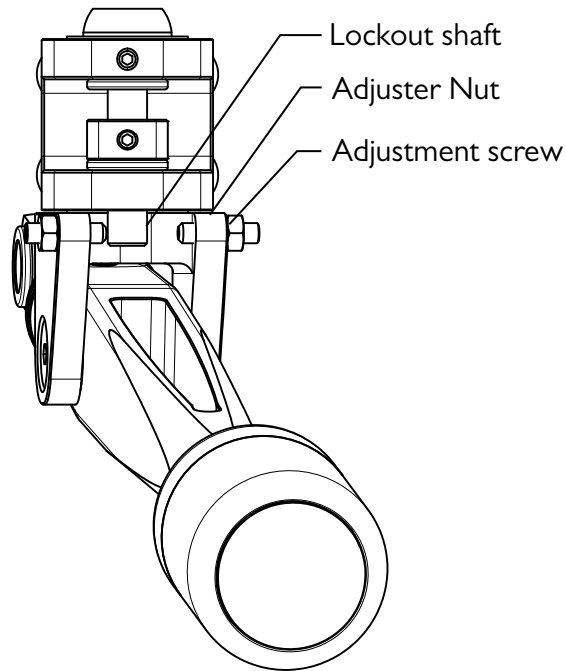

5. Place the shifter into **FIRST** gear
6. Adjust the set screw inwards and stop just before contact is made with the Lockout shaft
7. Hold Adjustment screw in place and lock the Adjuster nut
8. Confirm smooth operation into 1/2 gear adjust set screw if required

